

JL-SRB (Shaft with Rubber Bearing) Installation Guide

Product Contents:



- Dedicated Shaft (#1)
- Dedicated Bearing Mechanism, Lower Part of P.S. Pipe (#2)
- 2 Washers (#3)
- 2 E-Rings (#4)

Required Joystick:



JLX-TPML-8YT-SK Joystick. (Recommended for noise reduction)
For a quieter gaming experience, the JLX-TPML-8YT-SK is the superior choice, though other joysticks like JLF/JLX can be installed. The bearings contribute to a smooth operation, while the rubber reduces the impact noise upon contact with the guide plate.
Note: JL-SRB is specifically designed for Sanwa Denshi joysticks and is not compatible with other brands.

Installation Procedure:

1. Remove the guide plate (#5) from the joystick. Remove the switch part (#6) from the base.

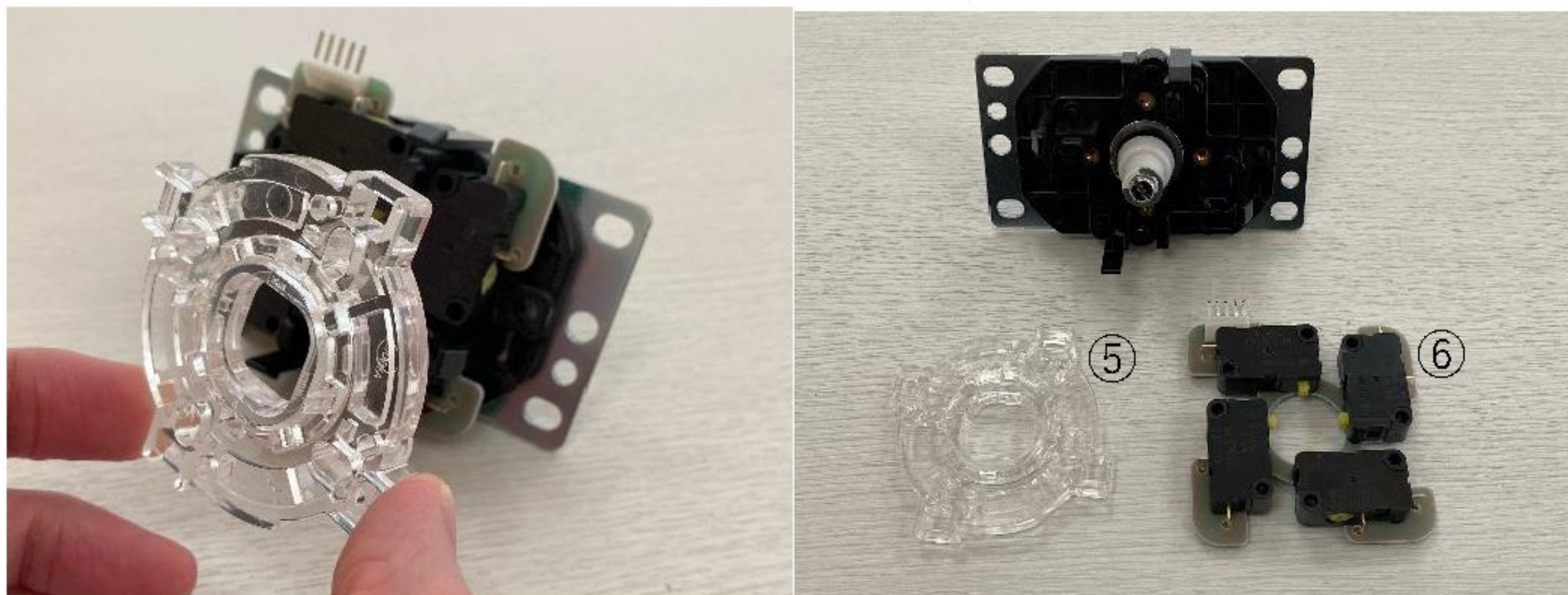

2. While holding the PS pipe, remove the e-ring and then the spring (#7), SP pipe (#8), shaft, and bearing (#9). Caution: The e-ring and spring may spring out during removal.

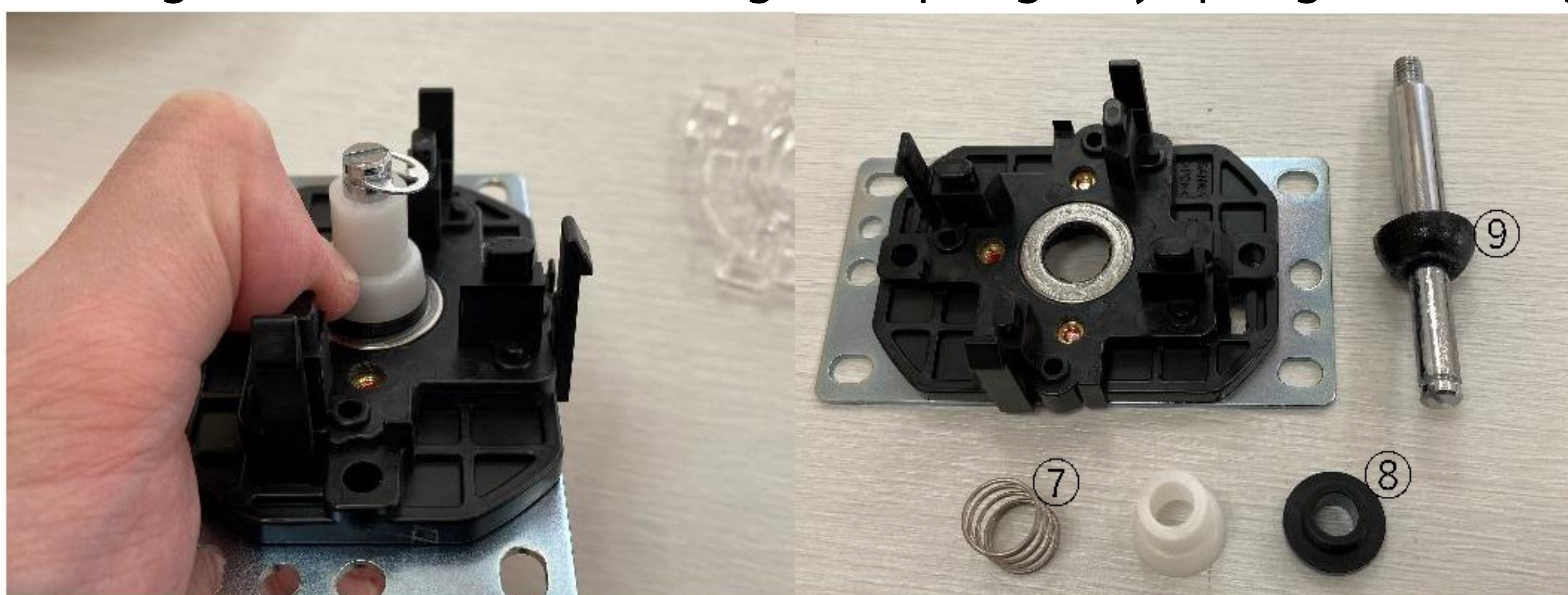

3. Attach the bearing (#9) to the shaft (#1) and insert them into the base. Attach the PS pipe (#8) and spring (#7).

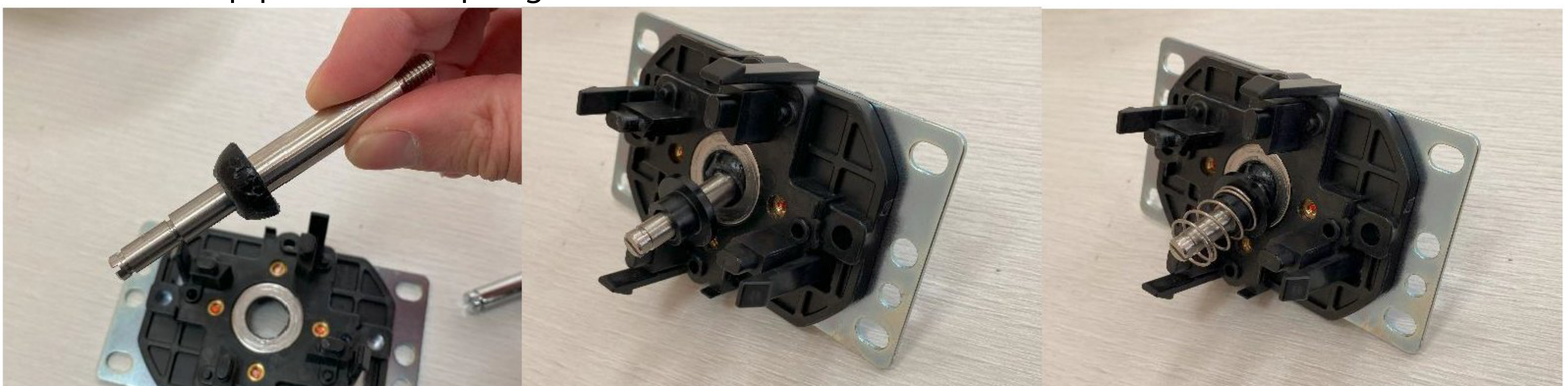

JL-SRB (Shaft with Rubber Bearing) Installation Guide

4. Attach the lower part of the PS pipe (#2) and secure it with the e-ring (#4), ensuring it's seated properly in the shaft's recess.



5. Install the washer (#3), rubber bearing (#2), and another washer (#3) in sequence.



6. Secure the assembly with the e-ring (#4).
Reattach the switch part (#6) and guide plate (#5).

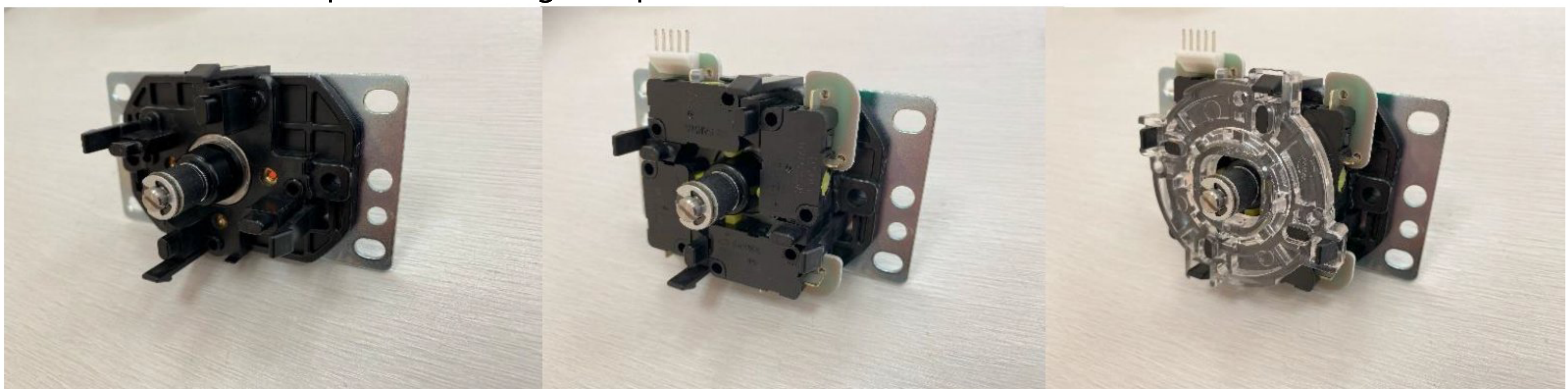

Important Note:

Due to the use of rubber components, the joystick's operation may feel stiffer over time, especially in certain environments.

To maintain smooth operation, apply a lubricant like Ichi-Nen Chemicals' Clear Lubricant Dry Type NX205 to the rubber surfaces.

Avoid applying lubricant directly to the switch, as this may cause malfunctions.

For optimal lubrication, either spray the lubricant onto the rubber surfaces while the joystick is assembled, or disassemble the joystick and apply lubricant directly to the rubber bearing.

Annual lubrication is recommended.